



Residences at 400 Central

£893,274-£6,241,267

Ref: LRE-66

St. Petersburg, Florida

The height of luxury begins at 400 Central, a 46-story, full service, luxury condominium tower with breathtaking views from Tampa Bay to the Gulf of Mexico and a full suite of owner amenities. Now under construction, The Residences at 400 Central offers an elevated approach to city living with a variety of floor plans from one to four bedrooms, plus a selection of penthouse homes. Modern, open-concept floor plans highlight the spacious interiors and generous terraces that accentuate the views. The Residences will include designer finishes package options in multiple styles and materials. Owners at 400 Central are greeted with luxury features and amenities, including a rooftop terrace with a tropical oasis pool and spa, bocce court, outdoor kitchen, pet station, recreation space and fire pit....

Telephone: +44 207 872 5525
Email: destinations@leadingRE.com

Leading
 REAL ESTATE COMPANIES
 OF THE WORLD

Gallery

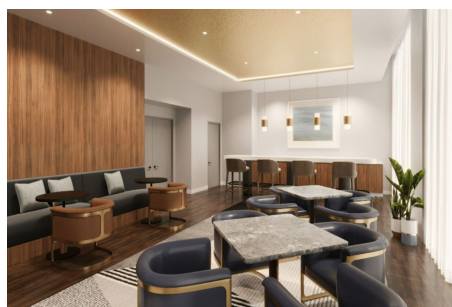

Telephone: +44 207 872 5525
Email: destinations@leadingRE.com

Leading
REAL ESTATE COMPANIES
OF THE WORLD

Property Details

Tenure: N/A

Location: 400 Central Avenue, St. Petersburg, Florida, United States

The height of luxury begins at 400 Central, a 46-story, full service, luxury condominium tower with breathtaking views from Tampa Bay to the Gulf of Mexico and a full suite of owner amenities. Now under construction, The Residences at 400 Central offers an elevated approach to city living with a variety of floor plans from one to four bedrooms, plus a selection of penthouse homes.

Modern, open-concept floor plans highlight the spacious interiors and generous terraces that accentuate the views. The Residences will include designer finishes package options in multiple styles and materials.

Owners at 400 Central are greeted with luxury features and amenities, including a rooftop terrace with a tropical oasis pool and spa, bocce court, outdoor kitchen, pet station, recreation space and fire pit. Interior amenities include a fitness and wellness center, upscale lounge, co-working space, state-of-the-art theater, catering kitchen, and dining room.

To showcase 400 Central's unparalleled, panoramic views, the top level features the Sky Lounge Observatory, a private amenity space that allows residents to enjoy and entertain in the height of luxury from 515 feet in the air.

Key Features

For Sale	Beds: 1 - 4	Baths: 2 - 3
Type: Condominium	24hr Security / Concierge	Central air conditioning
Cinema room	Leisure facility / Gym	Spa
Swimming pool		